

4107 Columbine Drive  
Austin, TX 78727

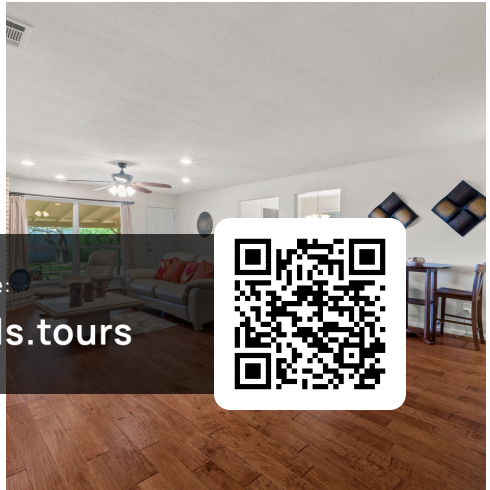

See online or with your mobile device:  
<https://4107columbinedrive.mls.tours>





TWIST TOURS

Not For Construction Purposes. See Architectural Plans for Details. Measurements are Approximate. See Seller for More Information.

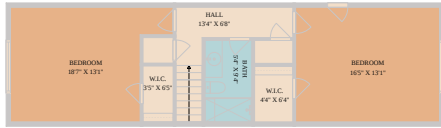

TWIST TOURS

Not For Construction Purposes. See Architectural Plans for Details. Measurements are Approximate. See Seller for More Information.



TWIST TOURS

Not For Construction Purposes. See Architectural Plans for Details. Measurements are Approximate. See Seller for More Information.

Home data report  
4107 Columbine Drive, Austin, Travis County, Texas, United States, 78727



Total Area: 2156 sq. ft.  
1st Floor: 1613 sq. ft., 2nd Floor: 543 sq. ft.  
Excluded: Garage 366 sq. ft., Deck 345 sq. ft., Embellishment 3 sq. ft., Walk: 179 sq. ft.

Property summary



Not published on PLS. See App. 2024-10-10 10:00 AM



**Elizabeth Riley**

REALTOR®

📞 512.658.0045

✉️ elizabeth@luxepg.com

🌐 luxepg.com/



© 2026 331 Enterprises, LLC. All rights reserved. This floor plan is an approximation of existing structures and features and is provided for convenience only with the permission of the seller. All measurements are approximate and not guaranteed to be exact or to scale. Buyer should confirm measurements using their own sources.

