

10513 Larue Pass
Austin, TX 78717

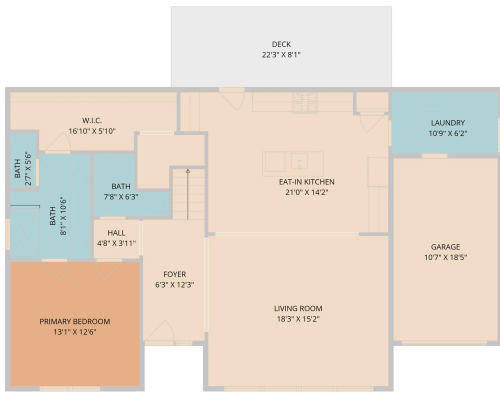

See online or with your mobile device:
<https://10513laruepass.mls.tours>





TWIST TOURS

Floor Plan Created by Calcsuite App. Measurements Deemed Highly Reliable But Not Guaranteed.

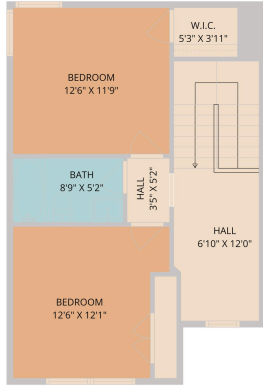

TWIST TOURS

Floor Plan Created by Calcsuite App. Measurements Deemed Highly Reliable But Not Guaranteed.



3RD FLOOR



1ST FLOOR

Floor Plan Created by Calcsuite App. Measurements Deemed Highly Reliable But Not Guaranteed.

Home data report
 10513 Larue Pass, Northwoods at Avery Ranch, Austin,
 Williamson County, Texas, United States, 78717



Total Area: 1725 sq. ft.
 1st Floor: 1172 sq. ft., 2nd Floor: 553 sq. ft.
 Excluded: Garage 194 sq. ft., Deck 182 sq. ft., Walls: 150 sq. ft.

Property summary

2 Floors, 3 Bedrooms, 2 Bathrooms

Scan captured on Sat, 25 Apr 2026 12:16:17 GMT



© 2026 331 Enterprises, LLC. All rights reserved. This floor plan is an approximation of existing structures and features and is provided for convenience only with the permission of the seller. All measurements are approximate and not guaranteed to be exact or to scale. Buyer should confirm measurements using their own sources.