

12716 Bismark Drive  
Austin, TX 78748



See online or with your mobile device:  
<https://12716bismarkdrive.mls.tours>





TWIST TOURS

Plan Not Created by ColorMap, Measurements General Rights Reserved. Not Guaranteed.

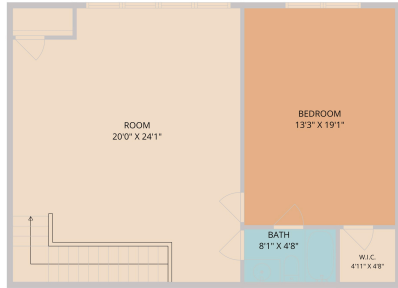

TWIST TOURS

Plan Not Created by ColorMap, Measurements General Rights Reserved. Not Guaranteed.



TWIST TOURS

Plan Not Created by ColorMap, Measurements General Rights Reserved. Not Guaranteed.

Home data report  
12716 Bismark Drive, Austin, Travis County, Texas, United States, 78748



Total Area: 3115 sq. ft.  
1st Floor: 2850 sq. ft. 2nd Floor: 915 sq. ft.  
Excluded: Garage 666 sq. ft. Patio 1122 sq. ft. Walks 205 sq. ft.

Property summary



Not updated on Thu, 10 Jun 2021 16:00:00 GMT



**Sam Archer**  
Principal Agent

📞 5126334650

✉ sam@archeraustin.com

🌐 <http://www.archeraustin.com>



© 2026 331 Enterprises, LLC. All rights reserved. This floor plan is an approximation of existing structures and features and is provided for convenience only with the permission of the seller. All measurements are approximate and not guaranteed to be exact or to scale. Buyer should confirm measurements using their own sources.